

COLLIER ALU DIAMETRE 50 DE 3CM 300 KG

CRA 5030

COLLIER ALU POUR TUBE Ø 50 MM
CHARGE 300 KG

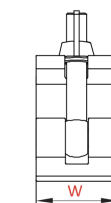
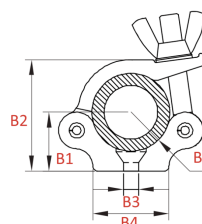

B1	39 mm
B2	73.5 mm
B3	10.5 mm
B4	50 mm
B5	Ø 48-51 mm
W	30 mm

S1 M10 x 40 mm



Poids : 0,3 kg

AL CRA5030

Principales caractéristiques

COLLIER ALU DIAMETRE 50 DE 3CM 300 KG. (Ref : AL CRA 5030)

