

Baby Quick Trigger Clamp

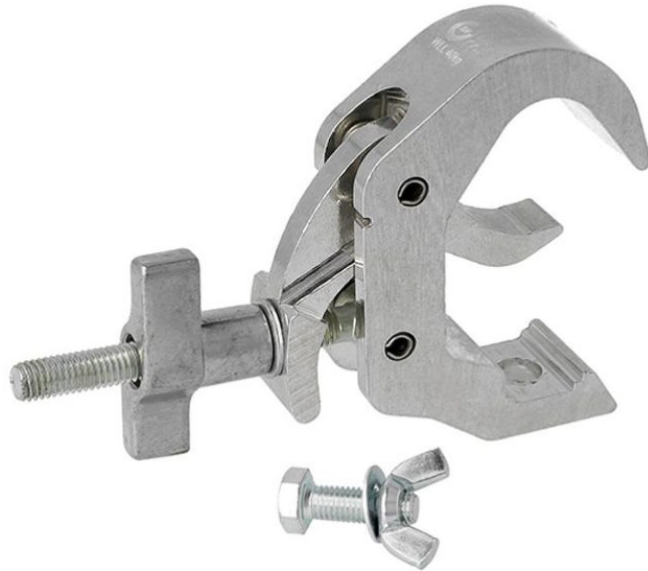

DO DT58150

Principales caractéristiques

Baby Quick Trigger Clamp . (Ref : DO D/T58150)

Baby Quick Trigger Clamp

A high tensile extruded aluminium quick trigger clamp that is suitable for 25mm to 38mm diameter tubes. It has a WLL of 40Kg and is 25mm wide. Slotted to hold captive an M8 or M10 nut or bolt head and supplied with an M10 X 35 bolt and wing nut. Ideal for smaller trussing as it will not damage the cords. Available in polished silver or powder coated black.

