



26020 IADI Fill 1000W 230V  
 26026 IADI Fill 1000W 120V USA

### Accessories

28004 Scrim Full Double  
 28005 Scrim Full Single  
 28006 GLASS CONVERSION FILTER ASSEMBLY  
 28007 SAFETY GLASS ASSEMBLY



**2595/179** WIRE GUARD ASSEMBLY

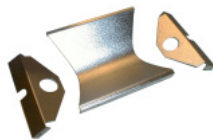

**2590/3** MIRROR PLUS MIRROR SIDE PANELS



**209/1** LAMPSOCKETS PACK OF 2 PIECES



**156/3** CERAMIC TERMINAL BLOCK E83-3 WAY 6MM



**261/10** CABLE CLAMP



**153/2** SWITCH 125V-20A 250V-10A



**5660/5** IN LINE SWITCH HOUSING BASE PLUS COVER



**2595/3** BARNDOOR LEAFS COMPLETE 2+2



**2590/9** STIRRUP SOCKET 16MM



**2590/10** COMPLETE MANUAL STIRRUP



**2590/150** STIRRUP LOCKOFF KNOBS AND HARDWARE KIT



**2590/6** IN LINE SWITCH CABLE ASSEMBLY 230V



**2590/12** IN LINE SWITCH CABLE ASSEMBLY 120V



N°	QC Pkg.N°	English	Italiano	Deutsch
----	-----------	---------	----------	---------

**Spare parts valid for both 120 and 230V versions**

1	2595/179	Wire Guard Assembly	Rete Di Protezione	Schtzgitter
2	2590/3	Mirror plus Mirror Side Panels	Specchio più Fiancattine	Reflektor und Reflektorseitenwaende
3	209/1	Lampsockets Mod. 209 / 2,5 - 560mm 230V CE Pack of 2 pieces	Portalampane Mod 209/ 2,5 - 560mm 230V CE - Conf.da 2	Socket Mod 209/2,5-560mm - 230V CE 2er Pack
4	156/3	CeramicTerminal Block E83 3way-6mm 230V CE / 120V cUL	Morsettiera in steatite E83 3Poli - 6mm 230V CE / 120V cUL	Klemmenleiste E83 3Pole - 6mm 230V CE / 120V cUL
5	261/10	Cable Clamp	Serracavo	Kabelhalterung
6	153/2	Switch 125V - 20A / 250V - 10A	Interruttore 125V - 20A / 250V - 10A	Schalter 125V - 20A / 250V - 10A
7	5660/5	In - Line Swich Housing - Base plus Cover	Custodia Interruttore	Schaltergehäuse
8	2595/3	Barndoor Leafs - Complete Set 2 + 2	Bandiere - Set Completo 2 + 2	
9	2590/9	Stirrup Socket 16mm	Boccola Attacco Spinotto 16mm	Huelse 16mm
10	2590/10	Complete Manual Stirrup	Forcella Manuale Completa	Bugel,Kompl
11	2590/150	Stirrup lockoff Knobs and Hardware kit	Kit Manopole Forcella piu viteria	Set für Bugelbefestigung und Bestigungsmaterial

**Spare parts valid only 230V versions**

12	2590/6	In - Line Switch Cable Assembly 230V CE	Complesso Cavo D'alimentazione 230V	AnschluBkabel 230V
----	--------	---	-------------------------------------	--------------------

**Spare parts valid for 120V versions ( not cUL approved )**

13	2590/12	In - Line Switch Cable Assembly 120V cUL	Complesso Cavo D'alimentazione 120V	AnschluBkabel 120V
----	---------	--	-------------------------------------	--------------------

N°	QC Pkg.N°	Espanol	Francais
----	-----------	---------	----------

**Spare parts valid for both 120 and 230V versions**

1	2595/179	Malla De Proteccion	Grillage De protection
2	2590/3	Reflector + Paneles laterales	Reflecteur plus les Cotès Polies
3	209/1	Portalampara Mod 209/2,5 - 560mm - 230V CE - Conj.de 2	Douille Mod 209/2,5 - 560mm - 230V CE Par 2
4	156/3	Bornes E83 3Poli - 6mm 230V CE / 120V cUL	Terminal E83 3Poles - 6mm 230V CE / 120V cUL
5	261/10	Abrazadera Cable	Serre - Cable
6	153/2	Interrupter 125V - 20A / 250V - 10A	Interrupteur 125V - 20A / 250V - 10A
7	5660/5	Alojamento Interruptor	Support Interrupteur
8	2595/3		
9	2590/9	Casquillo de estribo - 16mm	Supporte de Lyre - 16mm
10	2590/10	Estribo	Lyre
11	2590/150	Kit Fijacion Estribo	Kit Fixation Lyre plus Visserie

**Spare parts valid only 230V versions**

12	2590/6	Cable De Alimentación 230V	Càble D'Alimentation 230V
----	--------	----------------------------	---------------------------

**Spare parts valid for 120V versions ( not cUL approved )**

13	2590/12	Cable De Alimentación 120V	Càble D'Alimentation 120V
----	---------	----------------------------	---------------------------